

ATRIUM TERRACE LEVEL (AT)

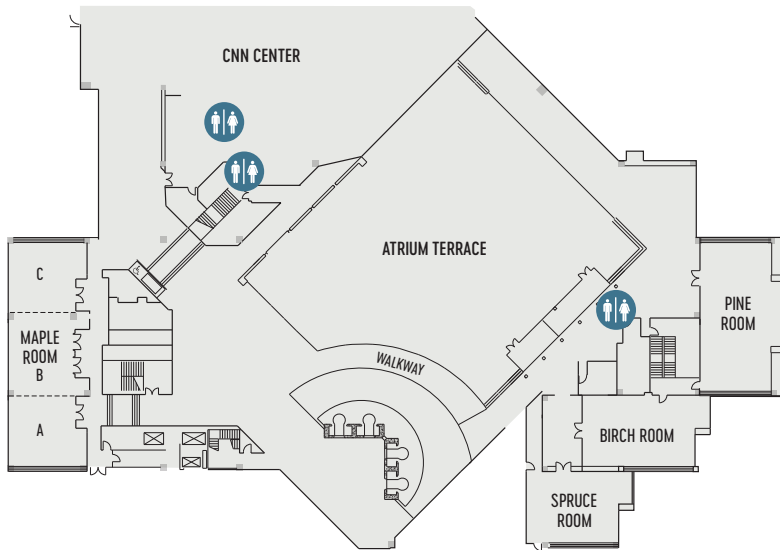

HOTEL LOBBY LEVEL

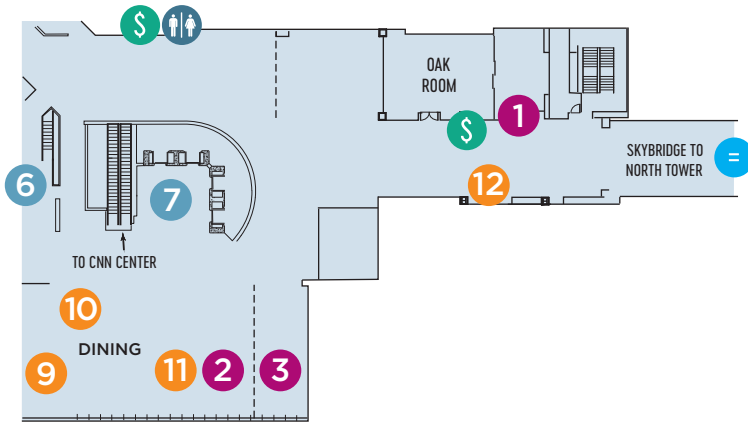

MOTOR LOBBY LEVEL (ML) & ACCESS TO CNN ATRIUM

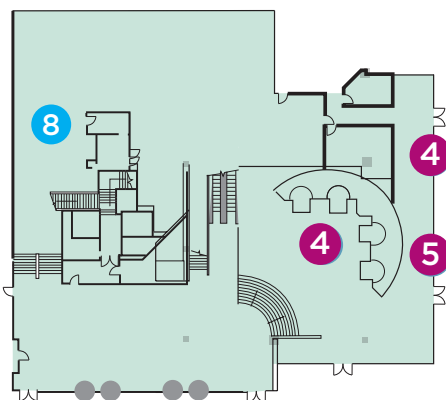

EXIT TO MARIETTA STREET & CENTENNIAL OLYMPIC PARK

OMNI

ATLANTA AT CENTENNIAL PARK

SERVICES

- 1 FedEx Office Business Center
- 2 Gift Shop
- 3 Front Desk
- 4 Valet
- 5 Bell Service

ELEVATORS

- 6 ADA Elevator
- 7 Guest Room Elevators (Hotel Lobby, Motor Lobby)

LANDMARKS

- = Skybridge
- 8 Walkway to CNN Food Court, State Farm Arena & Public Transportation

FOOD & DRINK

- 9 New South Kitchen
- 10 Vues Lobby Bar
- 11 Centennial Grounds
- 12 Top Draft

\$ ATM

RESTROOMS

FOOD & DRINK HOURS

NEW SOUTH KITCHEN

Wednesday – Sunday
6:30 a.m. – 2 p.m. | 5 – 10 p.m.

VUES

Wednesday – Saturday 4 – 11 p.m.

CENTENNIAL GROUNDS

Wednesday – Sunday 6 a.m. – 12 a.m.

TOP DRAFT

Wednesday – Friday 4 – 11 p.m.
Saturday – Sunday 11 a.m. – 11 p.m.

STANCE GRAB & GO FOOD

Wednesday – Sunday 6 a.m. – 8 p.m.

In Room Dining All Week

Breakfast 6 – 11:30 a.m.
Dinner 5 – 11 p.m.

*HOURS SUBJECT TO CHANGE

OMNI | NORTH TOWER

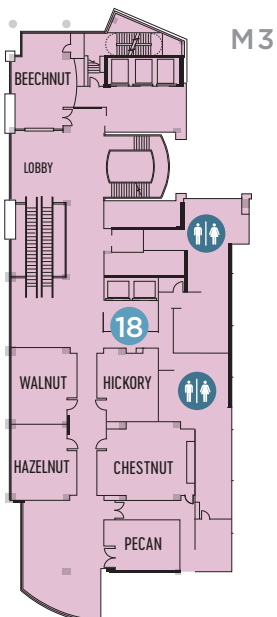
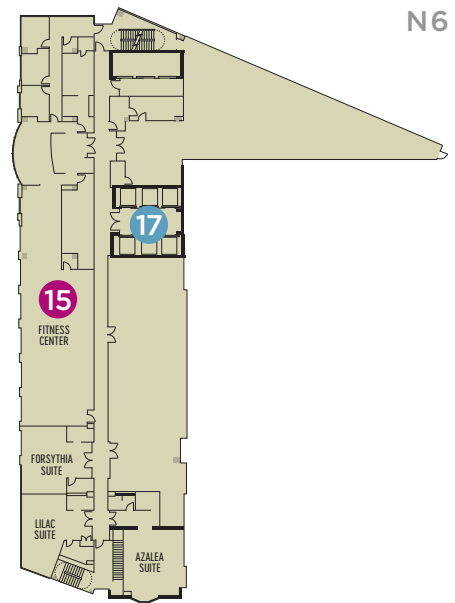
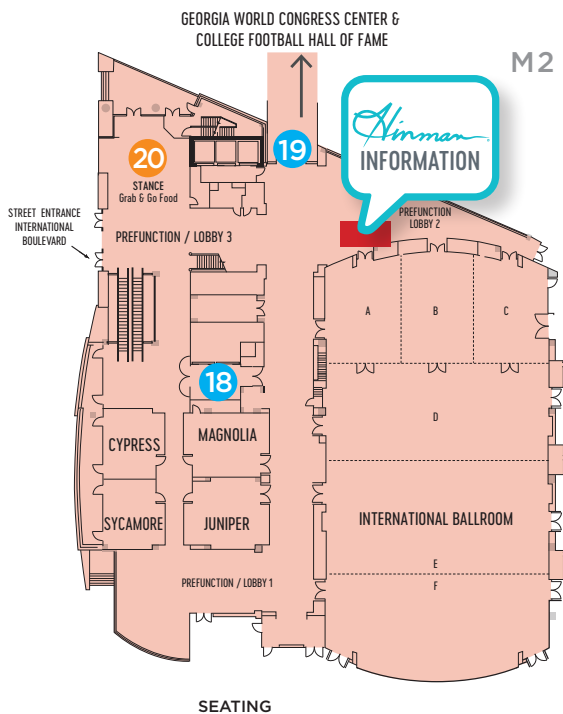
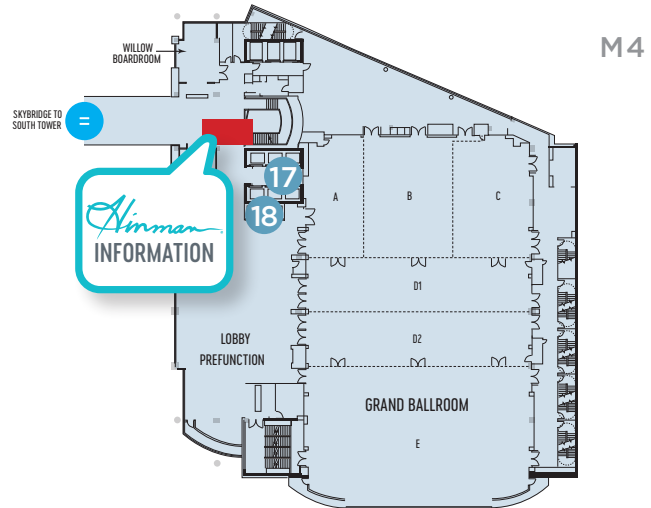
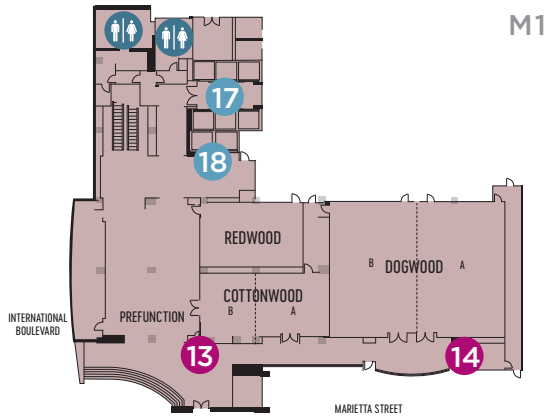

SEATING

SERVICES

- 13 Bell Services
- 14 Valet
- 15 24-Hour Fitness Center

ELEVATORS

- 17 Guest Room Elevators (M1, M4, N6 - 28)
- 18 Meeting Room Elevators (M1 - M4)

LANDMARKS

- = Skybridge
- 19 Walkway to Georgia World Congress Center & College Football Hall of Fame

FOOD & DRINK

- 20 STANCE Grab & Go Food

RESTROOMS

- \$ ATM