

OMNI | NORTH TOWER

SERVICES

- 13** Bell Services
- 14** Valet

LANDMARKS

- =** Skybridge
- 19** Walkway to Georgia World Congress Center & College Football Hall of Fame

15 RECREATION & ACTIVITIES

24-Hour Fitness Center

RESTROOMS

ELEVATORS

- 17** Guest Room Elevators (M1, M4, N6 - 28)
- 18** Meeting Room Elevators (M1 - M4)

FOOD

- 20** Grab 'N' Go Food



GEORGIA WORLD CONGRESS CENTER & COLLEGE FOOTBALL HALL OF FAME

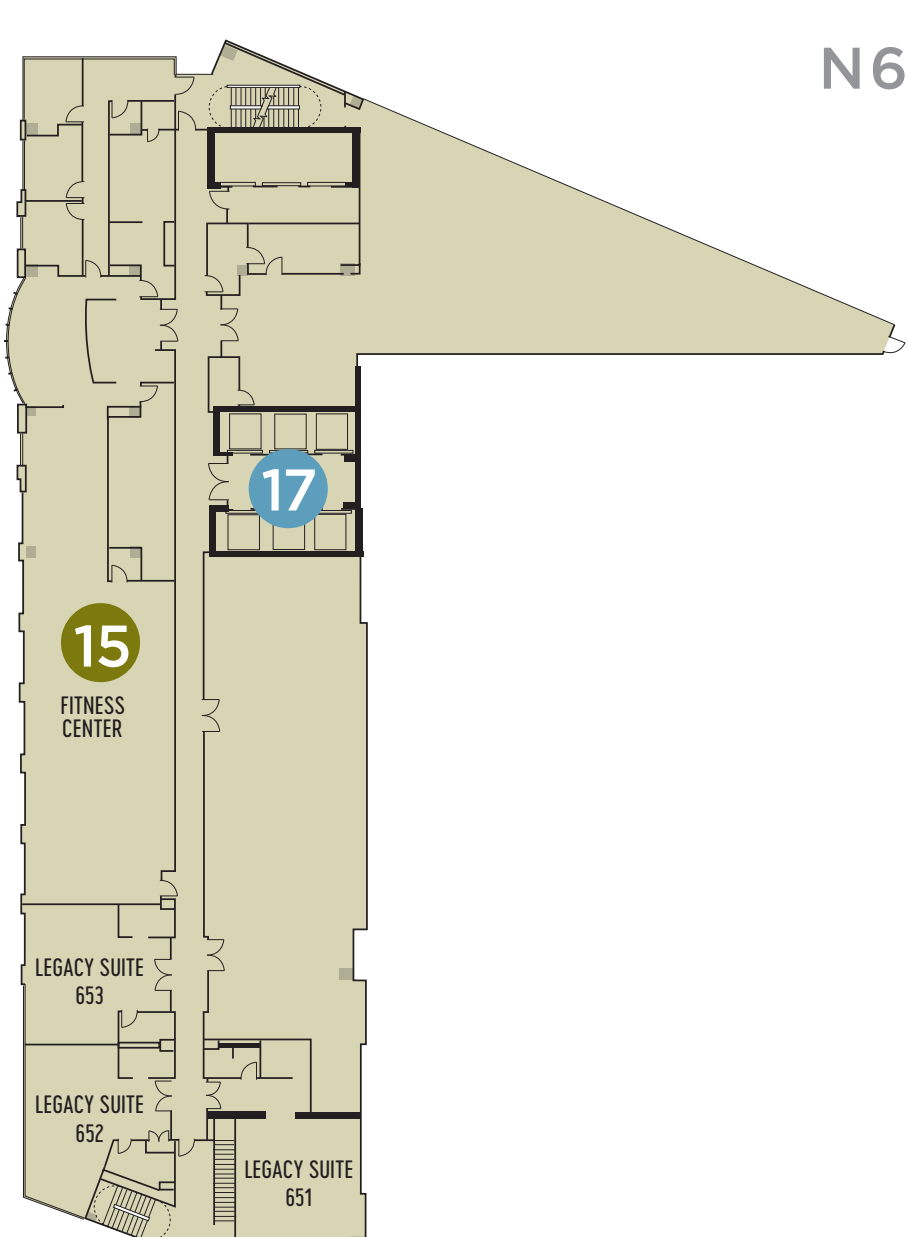
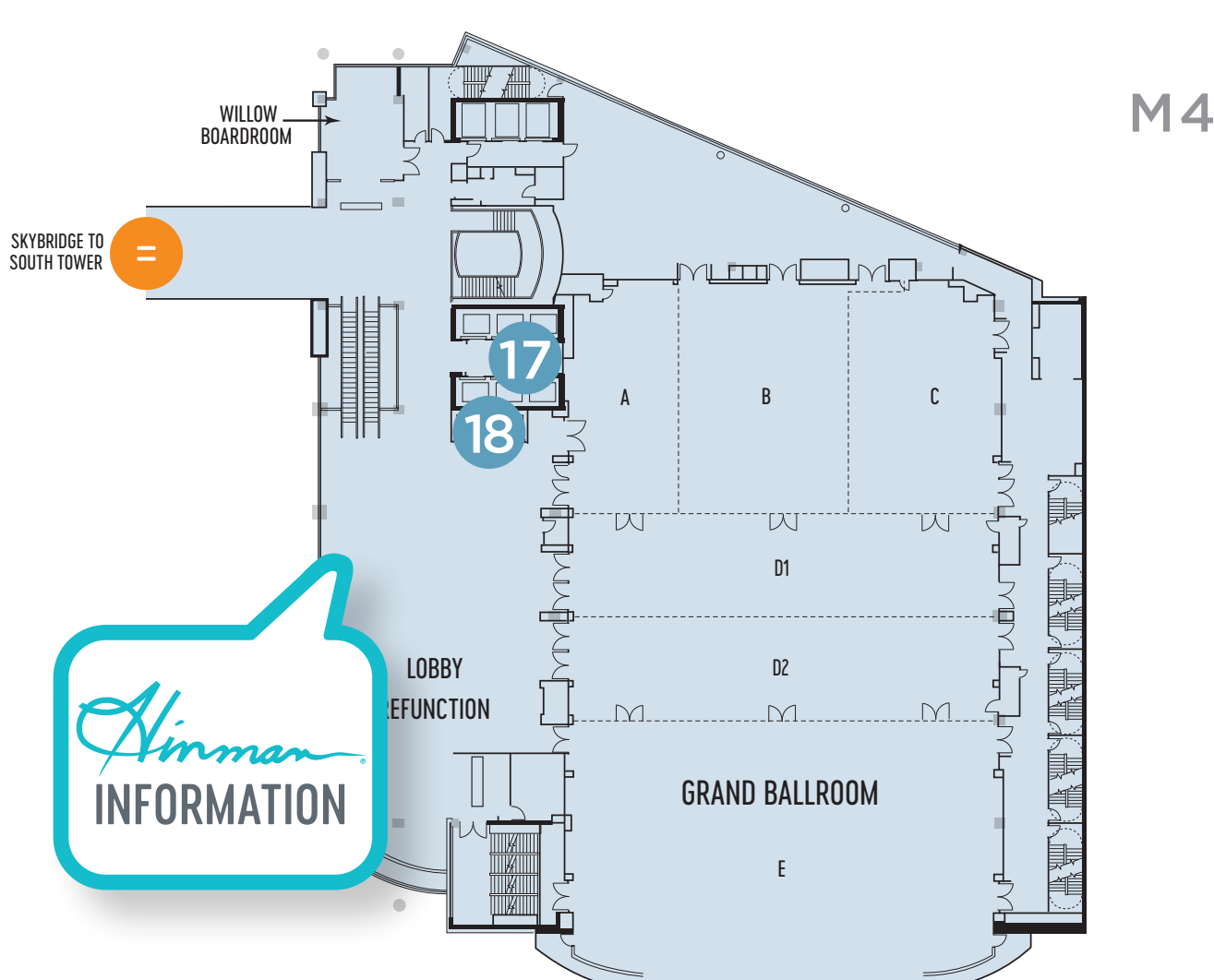
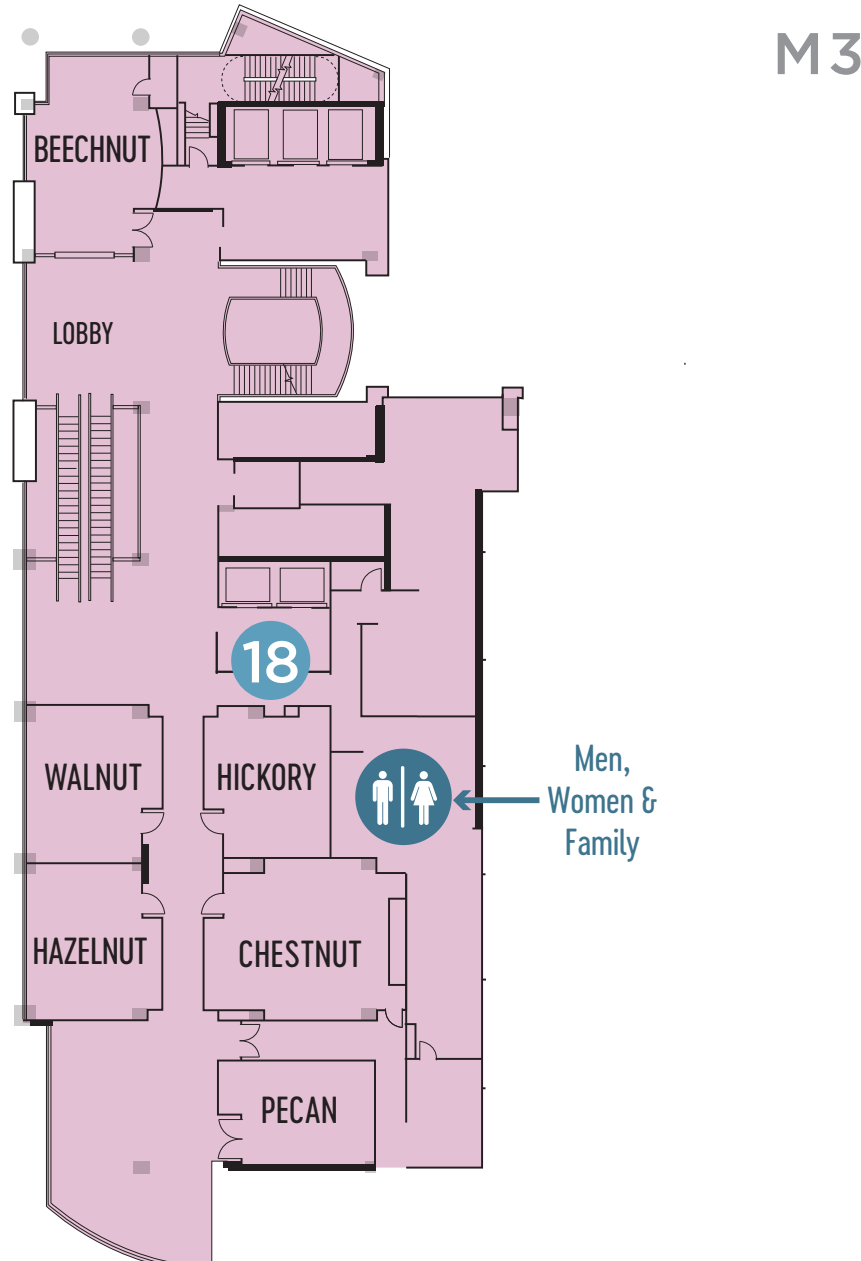

OMNI

ATLANTA
AT CENTENNIAL PARK

FOOD & DRINK HOURS

NEW SOUTH KITCHEN
Wednesday – Sunday
6:30 a.m. – 2 p.m. | 5 – 10 p.m.

VUES
Wednesday – Saturday 4 – 11 p.m.

CENTENNIAL GROUNDS
Wednesday – Sunday 6 a.m. – 12 a.m.

*HOURS SUBJECT TO CHANGE

TOP DRAFT
Wednesday – Friday 4 – 11 p.m.
Saturday – Sunday 11 a.m. – 11 p.m.

STANCE GRAB & GO FOOD
Wednesday – Sunday 6 a.m. – 8 p.m.

In Room Dining All Week
Breakfast 6 – 11:30 a.m.
Dinner 5 – 11 p.m.

OMNI | SOUTH TOWER

SERVICES

- 1 FedEx Office Business Center
- 2 Gift Shop
- 3 Front Desk
- 4 Valet
- 5 Bell Service

ELEVATORS

- 6 ADA Elevator
- 7 Guest Room Elevators
(Hotel Lobby, Motor Lobby)

LANDMARKS

- = Skybridge
- 8 Walkway to Food Court, State Farm Arena & Public Transportation

FOOD & DRINK

- 9 New South Kitchen
- 10 Vues Lobby Bar
- 11 Centennial Grounds
- 12 Top Draft

\$ ATM

RESTROOMS

HOTEL LOBBY LEVEL

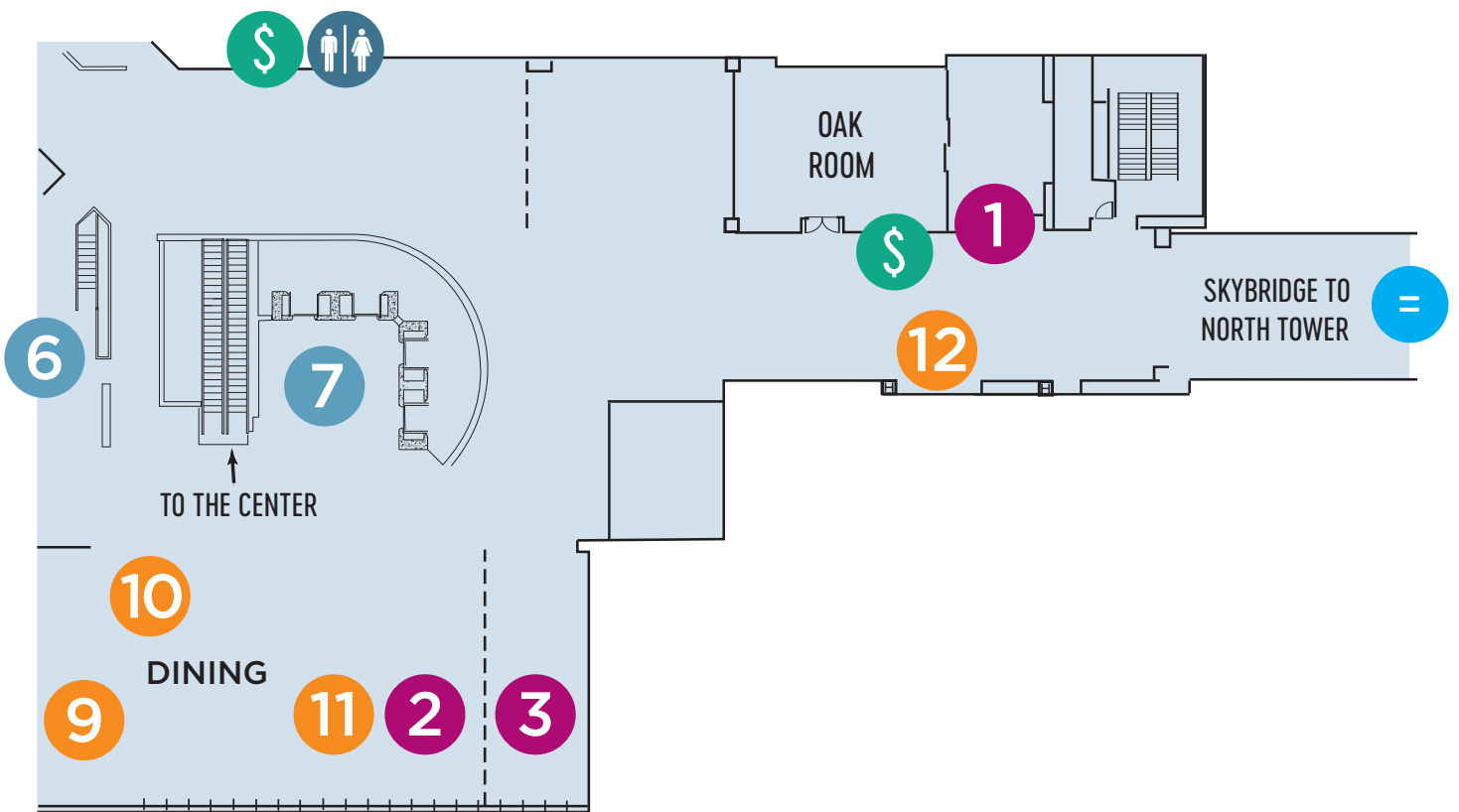

MOTOR LOBBY LEVEL (ML) & ACCESS TO ATRIUM

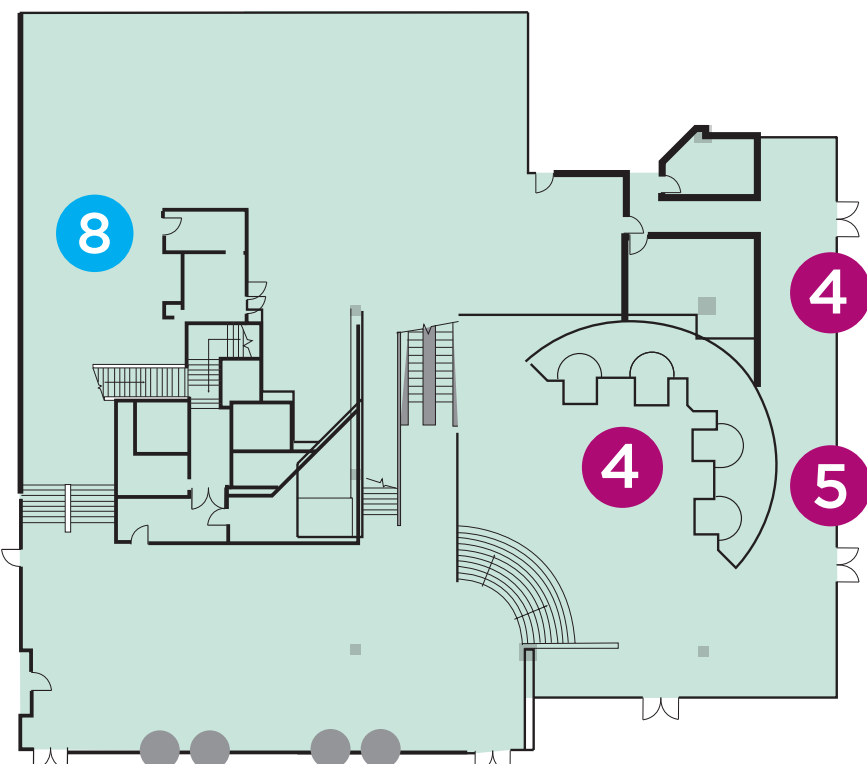

EXIT TO MARIETTA STREET & CENTENNIAL OLYMPIC PARK